

# User Manual & Parts Catalogue

## Ronco range of Blockcutters



# CONTENTS

<b>Topic</b>	<b>Pages</b>
Certificate of conformity	3
Introduction	4
Safety Information	5 – 13
Sharpening and replacing blades	14
Operating Instructions	15
Storage and Maintenance	16
Technical Data	17
Parts Diagrams	18
Warning Stickers	19
Safe Disposal	20

## **Manufacturer**

Coote Engineering Ltd, 12 Lisdoart Road, Ballygawley, Co. Tyrone, N. Ireland, BT70 2NG.

## **MACHINE DESCRIPTION**

### **Silage Blockcutter**

## **MANUFACTURERS "E.C." DECLARATION OF CONFORMITY**

We hereby declare, under our sole responsibility, that the above machinery

Complies with the provisions of the following EC Directives.

European Machinery Directive 2006/42//EC

### **Basis on which Conformity is declared.**

The above machinery satisfies the relevant essential health and safety requirements of the European Machinery Directive where appropriate.



Signed on behalf of the manufacturer.

Philip Coote

Managing Director



# Introduction

This Manual and Parts Catalogue is intended to assist the user to obtain maximum output from their machine. Careful attention to the section on day-to-day maintenance is of the utmost importance.

Read this manual carefully to learn how to operate and service your plant correctly. Failure to do so could result in personal injury or equipment damage. Follow all applicable safety regulations and recommendations in this manual as appropriate to your plant and the situation/conditions prevailing at the time.

Note: - When ordering parts using this manual, it is important to specify the machine type and serial number, in order to ensure that the correct parts are received.

## **WE RESERVE ALL RIGHTS**

No copies or reproductions may be made from this manual, parts lists or illustrations, without prior, written consent of COOTE Engineering. This Manual, complete or in part must not be loaned to a third party.

**Due to ongoing changes and revisions by our many suppliers it is often impossible to show all variations of any given assembly. Therefore, the right is reserved to alter any details contained in this manual without notice.**

## **NOTICE**

This Operation and Parts Manual, though sometimes helpful in the process of assembly/disassembly, is NOT intended to be assemble/disassemble instructions.

### **A Series Blockcutter Models**

A 210	2.1 Metres	[6'9"]	Bolt on blades, bolt in tines.
A 180	1.8 Metres	[5'9"]	Bolt on blades, bolt in tines.
A 150	1.5 Metres	[4'9"]	Bolt on blades, bolt in tines.

### **B Series Blockcutter Models**

B 270	2.7 Metres	[8'9"]	Bolt on blades, bolt in tines.
B 240	2.4 Metres	[7'9"]	Bolt on blades, bolt in tines.

## **FUNDAMENTAL SAFETY INSTRUCTIONS**

Without prejudice to the requirements in respect of training of employees under directive 89/655/EEC (provision and use of work equipment regulations 1992 (UK) it is vitally important that every person who operates this machine must have received instructions from a competent person as to its proper and safe use.

### **1.1 Basic operation and designated use of the machine.**

#### **1.1.1**

The machine has been built in accordance with state-of-the-art standards and the recognised safety rules. Nevertheless, its use may constitute a risk to life and limb of the user or of third parties, or cause damage to the machine and to other material property.

#### **1.1.2**

The machine must only be used in technically perfect condition in accordance with its designated use and the instructions set out in the manual, and only by safety – conscious persons who are fully aware of the risks involved in operating the machine. Any functional disorders, especially those affecting the safety of the machine, should therefore be rectified immediately.

#### **1.1.3**

The machine is designed exclusively to cut blocks of silage from a silage bunker/pit face. Using the machine for purposes other than those mentioned above is considered contrary to designated use. The manufacturer/supplier cannot be held liable for any damage resulting from such use. The risk of such misuse lies entirely with the user.

Operating the machine within the limits of its designated use also involves observing the instructions set out in the operating manual and complying with the inspection and maintenance directives.

### **1.2 Organisational measures**

#### **1.2.1**

The operating instructions must always be at hand at the place of use of the machine.

### **1.2.2**

In addition to the operating instructing, observe and instruct the user in all other generally applicable legal and other mandatory regulations relevant to accident prevention and environmental protection.

These compulsory regulations may also deal with the handling of hazardous substances, issuing and/or wearing of personal protective equipment, or traffic regulations.

### **1.2.3**

The operating instructions must be supplemented by instructions covering the duties involved in supervising and notifying special organisational features, such as job organisation, working sequences or the personnel entrusted with the work.

### **1.2.4**

Personnel entrusted with work on the machine must have read the operating instructions and in particular the chapter on safety before beginning work. Reading the instructions after work has begun is too late. This applies especially to persons working only occasional on the machine, e.g., during setting up or maintenance.

### **1.2.5**

Check – at least from time to time- whether the personnel are carrying out the work in compliance with the operating instructions and paying attention to risks and safety factors.

### **1.2.6**

Use protective equipment wherever required by circumstances or by law.

### **1.2.7**

Observe all safety instructions and warnings attached to the machine.

### **1.2.8**

See to it that safety instructions and warnings attached to the machine are always complete and perfectly legible.

### **1.2.9**

In the event of safety-relevant modifications or changes in the behaviour of the machine during operation, stop the machine immediately and report the malfunction to the competent authority/person.

### **1.2.10**

Never make any modifications, additions or conversions, which might affect safety without the supplier's approval. This also applies to the installation and adjustment of safety devices and valves as well as to welding work on load-bearing elements.

### **1.2.11**

Spare parts must comply with the technical requirements specified by the manufacturer. Spare parts from the original equipment manufacturers can be relied on to do so.

### **1.2.12**

Replace hydraulic hoses within stipulated and appropriate intervals even if no safety-relevant defects have been detected.

### **1.2.13**

Adhere to prescribed intervals or those specified in the operating instructions for routine checks and inspections.

### **1.2.14**

For the execution of maintenance work, tools and workshop equipment adapted to the task on hand are indispensable.

### **1.3 Selection and qualification of personnel – Basic responsibilities**

#### **1.3.1**

Only reliable personnel must execute any work with and on the machine. Statutory minimum age limits must be observed.

#### **1.3.2**

Employ only trained or instructed staff and set out clearly the individual responsibilities of the personnel for operation, set-up, maintenance and repair.

#### **1.3.3**

Make sure that only authorised personnel work on or with the machine.

#### **1.3.4**

Define the machine operator's responsibilities giving the operator the authority to refuse instructions by third parties that are contrary to safety.

#### **1.3.5**

Do not allow persons to be trained or instructed or persons taking part in a general training course to work on or with the machine without being permanently supervised by an experienced person.

#### **1.3.6**

Only personnel with special knowledge and experience of hydraulic equipment should carry out work on the hydraulic system.

## **1.4 Safety instructions governing specific operational phases.**

### **1.4.1**

Take the necessary precautions to ensure that the machine is used only when in a safe and reliable state.

### **1.4.1.2**

Check the machine at least once per working shift for obvious damage and defects. Report any changes (incl. Changes in the machine's working behaviour) to the competent organisation/person immediately. If necessary, stop the machine immediately and lock it.

### **1.4.1.3**

In the event of malfunctions, stop the machine immediately and lock it. Have any defects rectified immediately.

### **1.4.1.4**

Before starting up or setting the machine in motion, make sure that nobody is at risk.

### **1.4.2.1**

Observe the adjusting, maintenance and inspection activities and intervals set out in the operating instructions, including information on the replacement of parts and equipment. Only skilled personnel may execute these activities.

### **1.4.2.2**

Brief operating personnel before beginning special operations and maintenance work and appoint a person to supervise the activities.

### **1.4.2.3**

Ensure that the maintenance area is adequately secured.

#### **1.4.2.4**

To avoid the risk of accidents, individual parts and large assemblies being moved for replacement purposes should be carefully attached to lifting tackle and secured. Use only suitable and technically perfect lifting gear and suspension systems with adequate lifting capacity. Never work or stand under suspended loads.

#### **1.4.2.5**

Always tighten any screwed connections that may have been loosened during maintenance and repair.

#### **1.4.2.6**

Any safety devices removed for set-up, maintenance or repair purposes must be refitted and checked immediately upon completion of the maintenance and repair work.

#### **1.4.2.7**

Ensure that all consumables and replaced parts are disposed of safely and with minimum environmental impact.

### **1.5 Warning of specific dangers**

#### **1.5.1**

Hydraulic equipment

##### **1.5.2.1**

Work on hydraulic equipment may be carried out only by persons having special knowledge and experience in hydraulic systems.

##### **1.5.2.2**

Check all lines, hoses and screwed connections regularly for leaks and obvious damage. Repair damage immediately. Splashed oil may cause injury and fire.

##### **1.5.2.3**

Hydraulic lines must be laid and fitted properly. Ensure that no connections are interchanged. The fittings, lengths and quality of the hoses must comply with the technical requirements.

#### **1.5.4**

Oil, grease and other chemical substances.

##### **1.5.4.1**

When handling oil, grease and other chemical substances, observe the product-related safety regulations.

#### **1.6**

Sharp blades. Be aware that the equipment makes use of sharp blades in operation.

Carelessness or misuse can lead to injury or death.

#### **1.7**

Ensure the implement is correctly and securely attached to the operating vehicle using loader bracket mounting points.

#### **1.8**

Always use the correct mounting bracket and ensure that it is fitted by a trained and competent operator who has been approved by your Ronco dealer.

#### **1.9**

NEVER attach to a tractor which would be rendered unstable when the implement is operated at its full capacity. Take note of the maximum load permissible on loader or linkage arms.

#### **1.10**

Take extra care when operating machinery on sloping ground. NEVER operate on ground where there is a risk of the tractor becoming unstable.

#### **1.11**

When the unit is stationary always ensure it is lowered to the ground and in the grab is in the CLOSED position.

### **1.12**

When detaching the implement from the tractor always ensure that it is stable and safely positioned on a level surface.

### **1.13**

The attaching and detaching of the implement to a tractor must be carried out by only one operator. There should not be any other people in the vicinity of the implement or in the tractor.

### **1.14**

Before operation make yourself familiar with all elements and controls of the machine as well as their functions.

### **1.15**

Before operation inspect the area around you. Keep children away. All visitors and unauthorised persons should be kept well away from work area.

### **1.16**

Under NO circumstances should anyone, authorised or otherwise attempt to use the Blockcutter as a means of personal transport. It is designed as a specialist purpose farm implement and is unsuitable for the safe transportation of passengers. NEVER allow anyone especially children to travel anywhere between the tractor and an implement.

### **1.17**

NEVER use this implement to lift items other than silage.

### 1.18

ENSURE that the operator is aware of the large overhang when the Blockcutter is mounted on the front of the tractor. EXTREME CAUTION must be taken when emerging onto public roads.

### 1.19

EXTREME CAUTION must be taken if operating the Blockcutter near overhead power lines. All loading and unloading areas should be well away from overhead power lines. If a Blockcutter does come into contact with a power cable and it is necessary to leave the tractor, leave the vehicle by jumping well clear. Do not contact the ground and the vehicle at the same time, as this will complete the electrical circuit. Prevent anyone else from coming into contact with the vehicle while it is touching any power cable and contact the electrical supply company immediately!

#### CAUTION

Some attachments (e.g. buckets, manure forks, etc) can cause damage to the front tyres of a loader or tractor when lowered and the carriage is tilted forward. Exercise caution when lowering the boom.

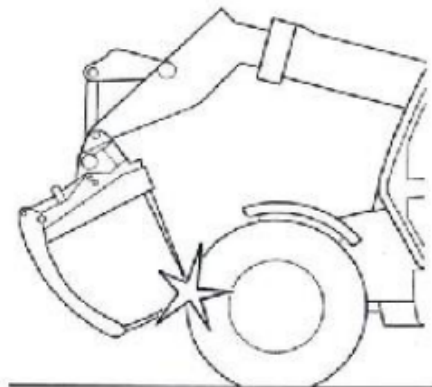

#### CAUTION

Do not extend the boom when an attachment is connected to the high flow auxiliary connectors.

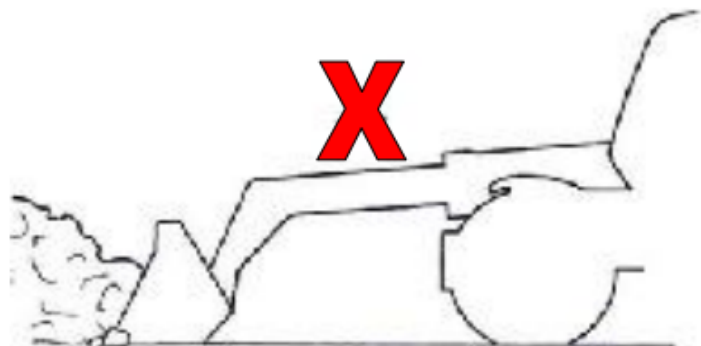

## Sharpening and replacement of blades

Using a 2nd cut flat file, place the file on the chamfered face of the blade and draw-file the blade face.

DO NOT file the flat of the blade.

ALWAYS ensure that heavy gloves are worn when sharpening the blade.

A ROTARY GRINDER MUST NOT BE USED TO SHARPEN BLADES AS THIS WILL DESTROY THE TEMPER OF THE STEEL.

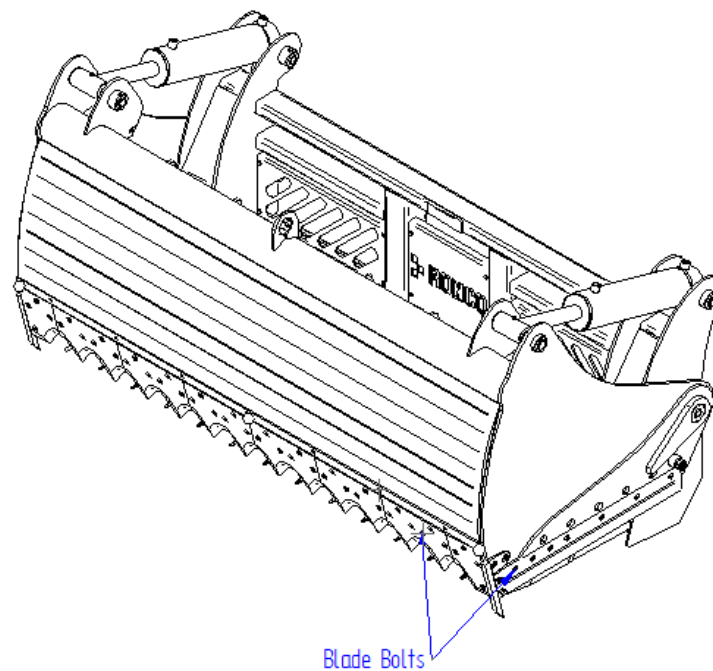

To replace the blades, carefully remove the blades bolts.

Ensure that at no point are hands or any other extremities are under the cutting edge of the blade when the bolts have been removed.

Once the blade has been removed, fit the new blade.

Ensure the bolts are tightened to a minimum of 48.7 lb-ft.

Dispose of the old blades responsibly.

## Operating Instructions

Before using the machine, it is extremely important to check that the blades are both clean and sharp. It is necessary to sharpen a new machine lightly to ensure efficient working. The operator should start at one side of the clamp and cut in one direction across the face, this will ensure a clean pit face and avoid secondary fermentation. The Blockcutter should be opened, and the tines levelled before being driven hard into the pit face. As the Blockcutter hydraulics are operated, the rams will be extended, and the blades will cut down through the silage. Care must be taken to hold the tines level and still, if necessary, powering down the arms to distribute the tractors weight will help hold the tines firm. When the Blockcutter is fully closed, it should be both lifted and crowned back to ensure a clean pit face.

### General Operating

1. Raise the grab until the top of the back of the grab is in line with the top edge of the silage. Do not a lift load that is taller than the height of a fully closed grab.
2. Drive the grab into the face of the silage until the tines are fully inserted.
3. Close the grab until the hydraulic rams have travelled fully. Open the cutter again by approximately 150mm (6 Inches) before removing the block. This is to prevent the overbite from catching silage when being removed.
4. Move the grab away from the silage face to remove the block. Before fitting the Blockcutter ensure that the tractor is suitably sized and is fitted with counterbalance weights. Always ensure that the silage is cut so that each block is centrally placed in the grab. Return the Blockcutter to the closed position when not in use. If feeding to livestock, ensure that the Blockcutter tines and blades are never allowed to come into contact with the livestock. If the Blockcutter is used to fill a feeder or other implement be careful to avoid contact between Blockcutter tines and metal surfaces or rotating paddles.

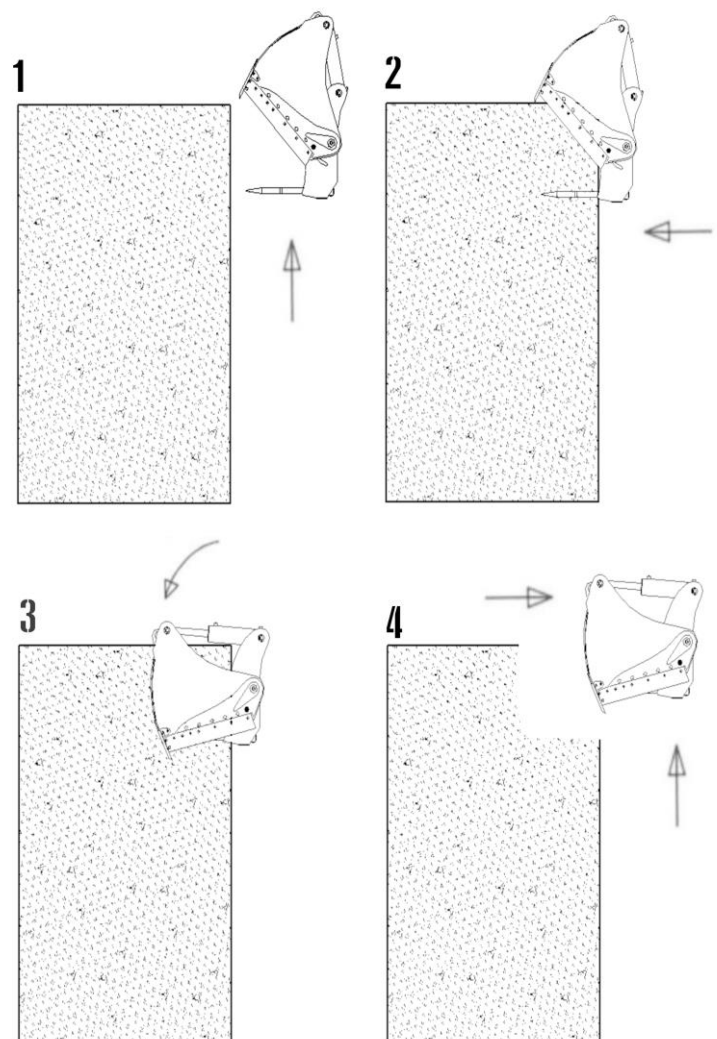

## Storage

Place the Blockcutter on a level surface.

Disconnect the grab from the tractor after turning off the engine and applying the brake.

Clean the machine thoroughly and remove any excess material that may be lodged in any pivot points.

Apply grease to the protrusion of the ram that is showing.

Cover the grab with a waterproof cover or store indoors.

## Maintenance

The diagram below shows the machine's grease points that should be greased daily.

These include the two main pivot points, and both ends of all hydraulic rams.

Check all hydraulic items for signs of wear and leakage.

### Keep blades very sharp.

Although the blades are of high-quality steel, they must have regular attention. They may require a few minutes of gentle fine filing just to maintain the edges. Any nicks and burrs must be filed away. In the event of a serious irreparable damage to the Blockcutter blades, replacement blades may be fitted, see page 14.

Over time the tines will wear back, once the tine is worn it is recommended that these are replaced. Contact your dealer for replacement pins, blades, tines, etc..

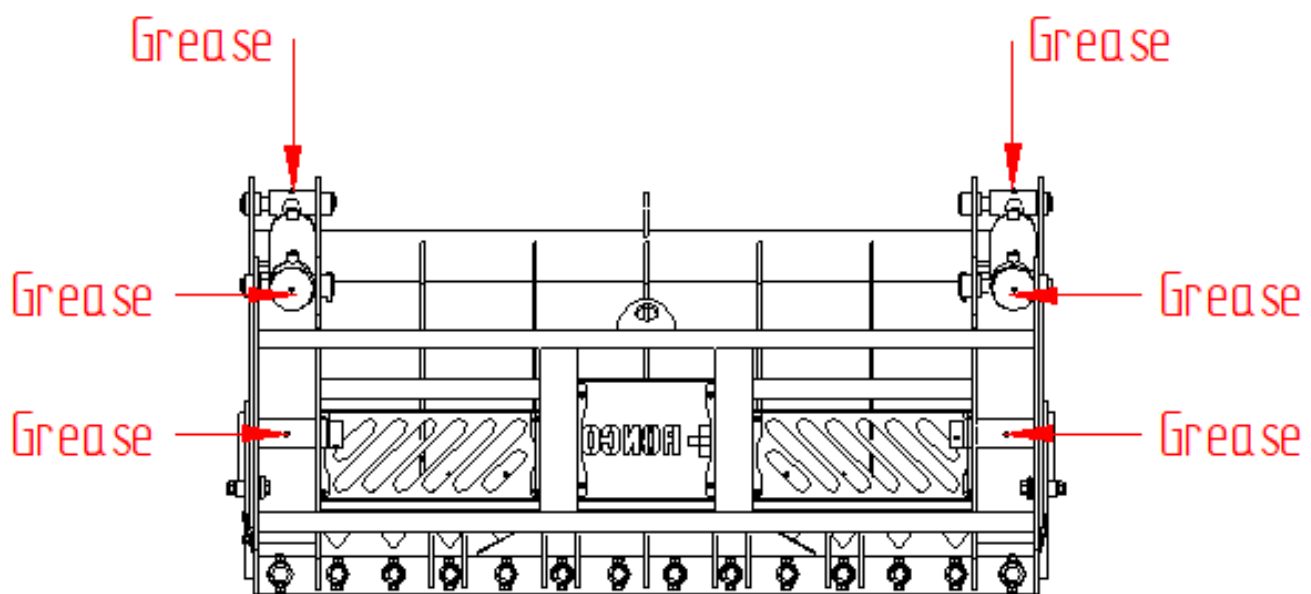

## Technical Data

Model	Rams	Capacity	Width	Height	Depth
A 150	2 X 110mm	0.86m <sup>3</sup>	1500mm	655mm	884mm
A 180	2 X 110mm	1.04m <sup>3</sup>	1800mm	655mm	884mm
A 210	2 X 110mm	1.21m <sup>3</sup>	2100mm	655mm	884mm
B 240	2 X 110mm	1.45m <sup>3</sup>	2400mm	655mm	923mm
B 270	2 X 110mm	1.63m <sup>3</sup>	2700mm	655mm	923mm

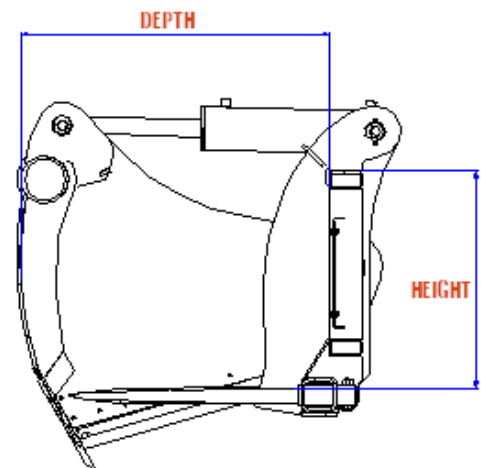
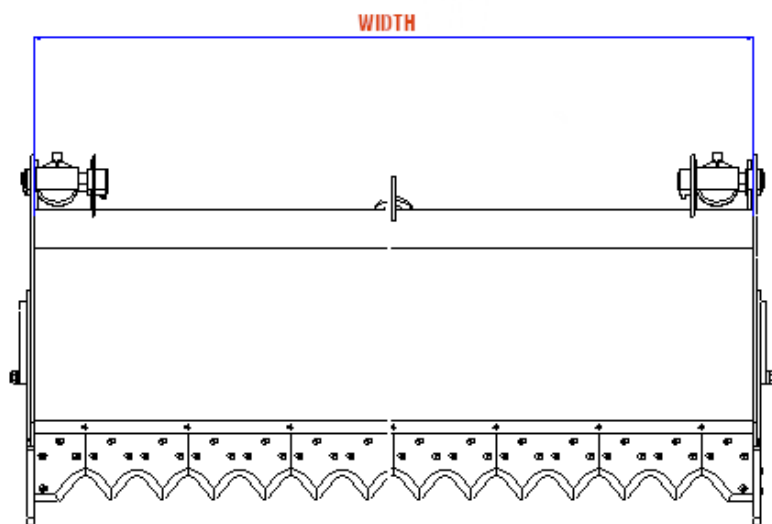

**We recommend that genuine Ronco bolt on brackets are used on these attachments. Any weld on brackets which adversely affect the structure of the product may invalidate warranty.**

## A SERIES SPARES

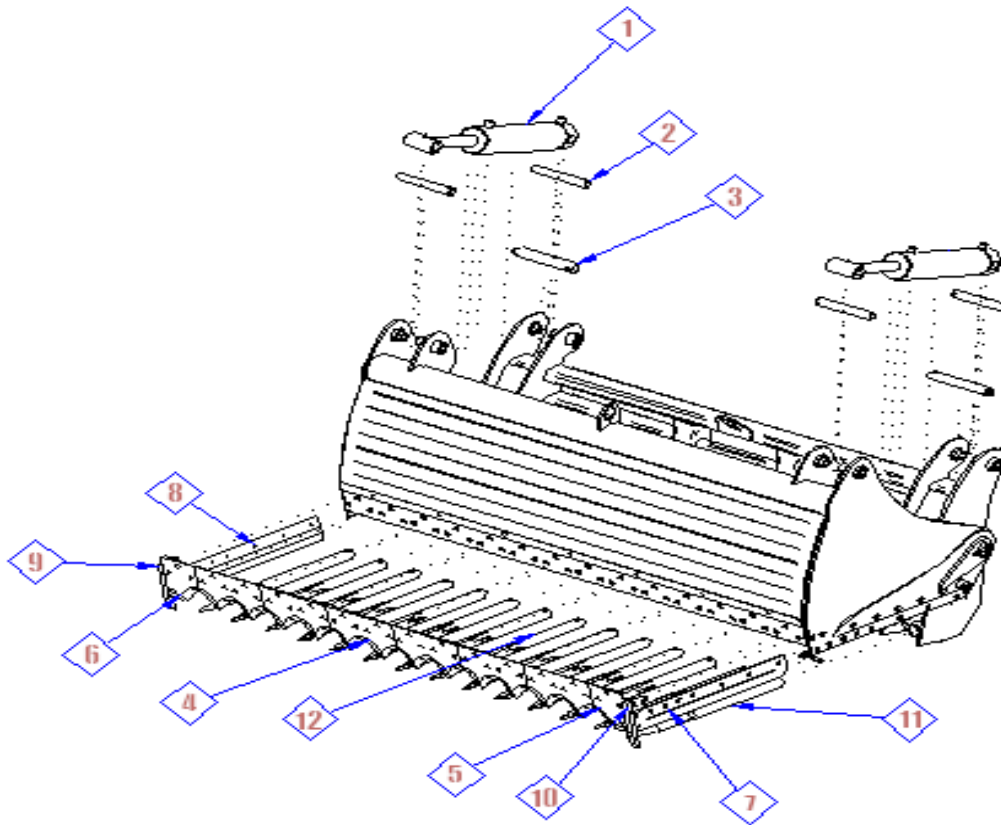

Item	Part Number	Description	Quantity
1	10.95.00047	A Series Ram	2
2	10.95.00096	A Series Ram Pin	4
3	10.95.00973	A Series Hinge Pin	2
4	NRB-013-00	A Series Centre Blade	A210 - 6 A180 - 5 A150 - 4
5	NRB-005-00	A Series L/H Blade	1
6	NRB-006-01	A Series R/H Blade	1
7	10.95.00099	A Series L/H Side Blade	1
8	10.95.00100	A Series R/H Side Blade	1
9	10.95.01074	A Series R/H Corner Toe	1
10	10.95.01074 O/H	A Series L/H Corner Toe	1
11	50mm Tine	A Series outside tine	2
12	45mm Tine	A series inside tine	A210 - 12 A180 - 10 A150 - 8

## Information markings

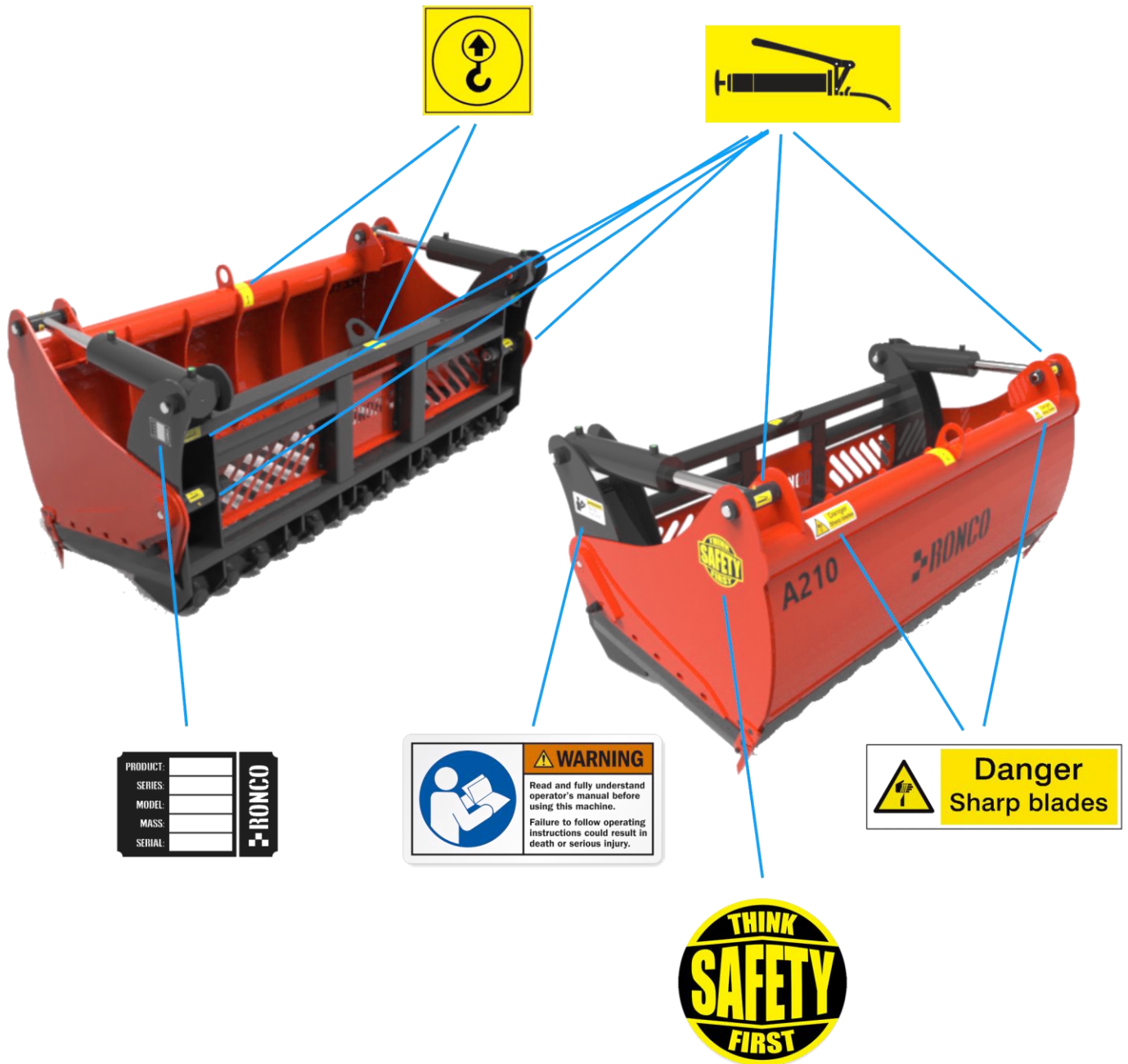



## **What you must do**

Store waste oil correctly

If you store any kind of oil on your premises, including waste oil, you must comply with Regulations for Oil Storage.

## **Oil storage**

You must store all your waste securely and comply with your duty of care.

## **Dispose of waste oil safely**

Waste oils, except edible oil, are classed as hazardous/special waste and should be disposed of accordingly. Wastes contaminated with oils, for example oily rags, would in most cases be classed as hazardous/special waste. If you have waste oil to dispose of, make sure it is taken or collected for recycling by a licensed business.

You must not mix waste oil with any other materials, including different types of oils. If you mix hazardous/special waste with other materials, the whole load will be classed as hazardous/special waste. This will make it more expensive for you to dispose of. You must have an appropriate permit or licence if you want to mix different types of hazardous/special wastes.

You must not tip oil into drains or onto land as this can result in the pollution of rivers and groundwater and cause land contamination.

You must not burn waste oil on a bonfire as this will cause air pollution.

## **Good practice**

If you use oil filters, for example for engine lubricating oil, you should drain waste oil from the filters and send them as hazardous/special waste to be crushed and recycled. This also makes the waste oil easier to handle and to send for recovery.